



Friends of Prince of Wales Park

26th June

How have we got on planting up the Cascade? What has happened to the paths after the heavy rain? What is the Fungus of the week? All of these questions and more will be answered in this edition of the eNews.

If you saw the last edition, you will have seen that the Friends received their order of plants ready for the new bed at the top of the cascades. Planting morning arrived and a small army of volunteers mustered to first transport the plants up hill to the Cascades and then to plant them out.



The weather for the work was ideal being cool and drizzly. As the plants arrived so did the man with the plan.

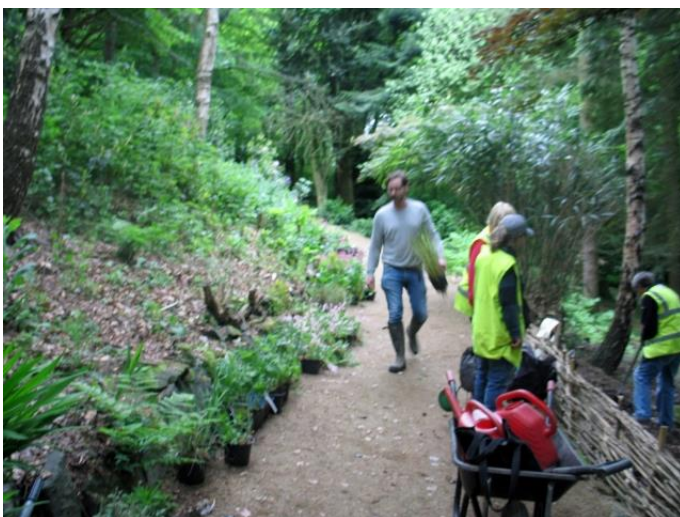

A lot of this work has gone on behind the scenes in terms of layout and plant selection. After close collaboration with Bradford Parks, our Horticulturists set about transforming a drawing on paper into the finished flower bed.

Here we have the plan for the bed.

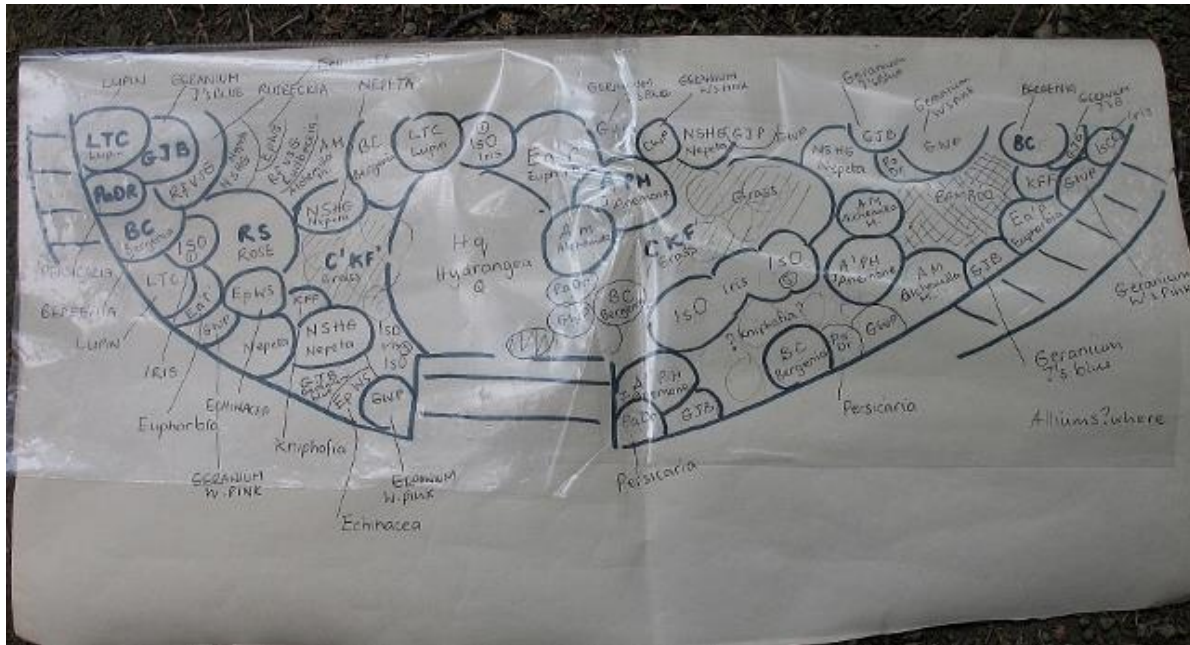

And here is the colour scheme

Not everything follows the plan as on the day slight tweaks and adjustments are made.

Taking us from this.



Through this.



To this.



And the finished bed? Off you go and have a look. Hopefully it will have survived the recent heavy rain. This is yet another example of how your donations are being spent. The plants here were around £300. You can see how much we need your help to keep this work up.

On to question two. What has happened to the paths after the heavy rain? As we now sadly expect, lots of sand has been moved down through the park. The plus side is that we have our own beach down near the drinking fountain.



We are thinking of renting out deck chairs and selling donkey rides to raise much needed funds. The down side is that the sand had to come from somewhere and that somewhere is the surface of the paths at the top, steepest parts of the park. In the past, we have barrowed the sand back up the hill on at least four occasions, not because we think it will stay there but to try to repair the damage.

This repair is just at the college entrance path. We don't expect it to last but at least it will buy us some time to plan what we can do to stop it happening with such frequency.

Our current plan is to install more groynes and soakaways on the steeper parts of the main path. As usual, it will all have to be done by hand so if you are up for a bit of ditch digging please let us know, we could do with some more muscle!



As you walk through the park, please take care on the rutted sections of paths and the loose surfaces. Hopefully future work will reduce the damage. Another method of protecting the paths from heavy rain water run-off is by raising the groynes stones slightly. Also closing gaps between them. This encourages the water to flow into the associated soakaways. In this picture the stones have been raised slightly. This is hard work as these stones are heavy and have probably been there since the park was first laid out.

Although many of the problems seem to be on the sandy side of the park, the tarmac side has its own challenges. It too has soakaways and these need to be cleared. As we have worked our way up (or down) the path, it becomes clear that the drainage in this area has been “creatively” managed. We have lost drain grates, cemented in drains, stone lined soakaways and simple ditches which we can only presume once had stone linings.



As these have been cleared and other drains identified, we have a clearer picture of how the system on this side of the park worked.

Along the tarmac path there appears to be a large pipe (underground) into which smaller pipes connect which are supposed to carry run off water. As the drains move down the park, they disgorge into several sumps from which the smaller pipes radiate out to the larger gauge pipes. Sadly, over the years, these pipes have become packed with earth and need jetting out. Using drain rods is simply not possible. Also over the years, tree roots have moved and realigned the pipes so they now leak. The consequences are that large areas are boggy and un drained. Hopefully armed with this knowledge, and our Drainman, we can make some more positive improvements in the future.

Whilst all of the planting and drain work is being done, the “house work” piles up. All of the weeding and path tidying jobs still need attention. As can be seen, our volunteers have set about tidying up the lower tarmac path entrance.



As they progress, some planting is being done on each side of the path.



Sadly, our volunteers are being struck down with what could be a deadly disease!



Their knees appear to become spotty and swollen! Hopefully they will make a full recovery...or their knees may drop off!

Although our beautiful azalea walk has lost its blossoms, other areas are starting to show a little colour.



Don't forget that we have 2 for one Kew Gardens tickets going begging!
Yes, that's 2 for one and they are free to a good home. The offer is open until 31st December 2016, so think, summer holidays or a winter visit to London with a visit to Kew....go on, you know you want to!

Exclusive two-for-one offer to visit Kew Gardens



Discover the world's largest collection of plants and explore 300 acres of stunning landscapes. Simply fill in one of the vouchers below and hand it in at the entry gates.

2 for 1 Visit Kew Gardens with our exclusive two-for-one offer. Simply fill in this voucher and hand it in at Kew Gardens.

Your name: _____
Your email address: _____

One adult admitted free when accompanied by an adult paying full price. Where full price and

Terms and conditions

- Offer redeemable by completing this voucher and handing in at one of the entry gates
- Tickets non-exchangeable and non-redeemable for cash and cannot be used in conjunction with any other offer
- One voucher per person and photocopies not acceptable
- Kew Gardens reserves the right to refuse entry

If you want some just let us know, first come first served.

We want the Fungus of the week! We want the Fungus of the week! I know how much you all look forward to this, so we have a special treat! Not only do we have TWO fungi but details of the last fungus from our Official Unofficial Mycologist.



This is the "Happy fungus". The people who showed me this assured me that no-one had drawn a face on this fungus and that it was all completely natural! Now, do we really believe them?

This one was not seen by the volunteers who found the Happy fungus so we can be reasonably sure that it is authentic.



And reflections on the last Fungus of the week from our Mycologist:

"I have had a look at the fungus in newsletter 119. The fungus which is growing on a tree stump is *Trametes (Coriolus) versicolor* or the "many zoned polypore". This is a thin bracket fungus that is variable in colour and in this example includes browny-ochres and blues. A key feature of this fungus is the concentric zones of different colours. A curious thing about this fungus is that some brackets are found attractive enough to be dried, which retains the colours and then mounted on small pieces of wood with a pin to make a brooch."

Is this a significant finding?

Seemingly buried along the side of the cascade we have found this:



It's not a drain pipe but seems to be a conduit for an electrical cable and may have been how the fountains in the cascade were powered. As the only source of electricity was either at the Lodge or on the tarmac path (there was once a street light halfway down the path) any cable would need to be protected before being buried. We can't see the cable here but one old cable was found near the Lodge garden, heading uphill some months ago. Who knows?

What's happening in the park over the next few weeks?

Coming up!

- 1) A Historic Walk through Prince of Wales Park July 10th 2pm with Allan Mirfield
Lady Lane/ Main Entrance
- 2) August 14th Susan Stead Butterfly Walk
2pm Eldwick Entrance
- 3) Forest school on August 18th (a day of fun)
price £10
- 4) Sept 9th Robert Bells Bat Walk. (time to be confirmed)
- 5) Bill Frazer Fossil walk Sunday Sept 11th (time to be confirmed)



As we get more information, we will let you know, so mark these in your diary and let's hope for nice weather.

What June delights has the park given us?

- Cascades kaleidoscope
- Sandscapes in the paths
- Deluge in the drains
- Spotty knees nasties
- Conduit conundrums

Our small army of volunteers have done it again turning out to help plant out the Cascade bed. As if to illustrate that you can't please everyone, I had a chat with two park visitors whilst the work was being done. The first was reassured that we had a planting plan and were following it. The second person was concerned that we had a planting plan and were following it, preferring a less structured approach. Oh, well I doubt if we can manage to give everyone exactly what they want. But to everyone I would say, remember how the park was just two years ago. Love the work or hate it you must admit that there have been some improvements. However, the work can't be done without money. As our only sources of income are donations and membership fees, we thank all of you who have helped. For those who have not, we urge you to consider helping us out if you can.